

"20" TRACTOR PARTS LIST

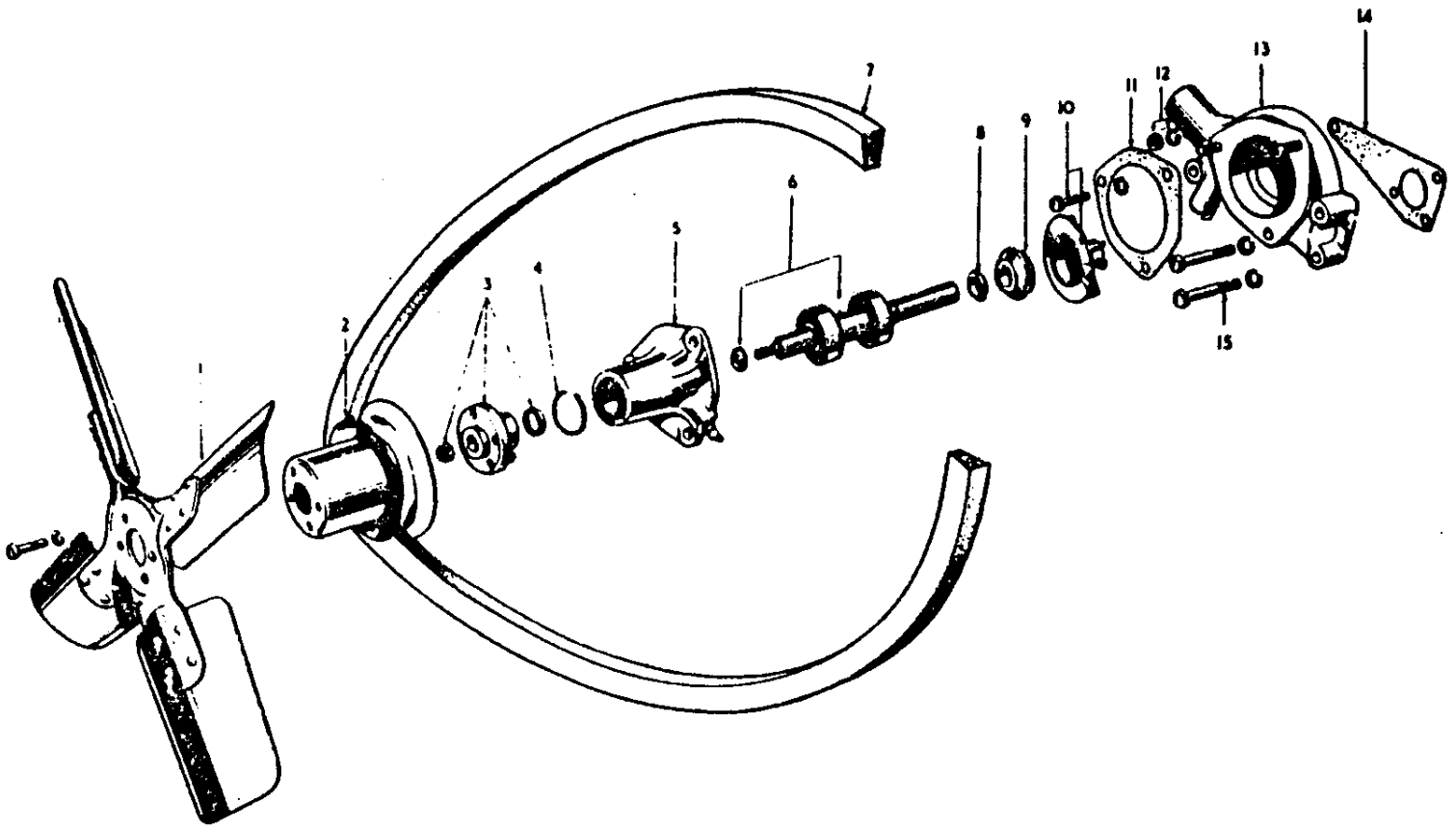

FIG. 48A

AGCO Corporation
Parts List Report

Massey Ferguson (Europe)

TE 20 TRACTOR

Page 172 - WATER PUMP ASSEMBLY AND FAN (NEW DESIGN) - 80 M/M PET.

Item	Part Number	Qty	Part Description	Comments
				80 M/M PET.
				85 M/M PET.
				85 M/M V.O.
				85 M/M L.O.
				20C DIESEL
	500088	1	Pump	80 M/M PET.
				INCL. REF. 2 - 6, 8 - 13
	500088	1	Pump	85 M/M V.O.
				INCL. REF. 2 - 6, 8 - 13
	825843M91	1	Pump	85 M/M PET.
				INCL. REF. 2 - 6, 8 - 13
	825843M91	1	Pump	85 M/M V.O.
				INCL. REF. 2 - 6, 8 - 13
	825843M91	1	Pump	85 M/M L.O.
				INCL. REF. 2 - 6, 8 - 13
	826119M91	1	Pump	20C DIESEL
				INCL. REF. 2 - 6 8 - 13
1	825181M91	1	Fan	80 M/M PET.
1	825181M91	1	Fan	85 M/M PET.
1	825181M91	1	Fan	85 M/M V.O.
1	825181M91	1	Fan	85 M/M L.O.
	826130M91	1	Fan	20C DIESEL
	825363M1	1	Balancer	
	353792X1	4	Bolt Unf	
	353446X1	4	Lock Washer	
2	825378M91	1	Pulley	80 M/M PET.
2	825378M91	1	Pulley	85 M/M PET.
2	825378M91	1	Pulley	85 M/M V.O.
2	825378M91	1	Pulley	85 M/M L.O.
	826121M91	1	Pulley	20C DIESEL
3	825377M1	1	Hub	
	825380M1	1	Cotter	
	353916X1	1	Nut Unf	

	353446X1	1	Lock Washer	
	825379M1	1	Spacer	
	825372M1	1	Washer	
	NN2908	1	Nut	1/14" N.F.
4	825371M1	1	Ring	
	825440M91	1	Water Pump	INCL. REF. 3, 4, 5, 6 AND 8
5	825447M1	1	Housing	
	MP1058	1	Nipple	
6	825375M1	2	Bearing	
	825743M1	1	Spindle	
	825370M1	1	Spacer	
	825376M1	1	Washer	
	825471M1	1	Circlip	
7	641696M1	1	Belt	80 M/M PET.
7	641696M1	1	Belt	85 M/M PET.
7	641696M1	1	Belt	85 M/M V.O.
7	641696M1	1	Belt	85 M/M L.O.
	826960M1	1	Belt	20C DIESEL
8	825309M1	1	Seal	
9	825374M1	1	Seal	
10	825742M1	1	Impeller	
	500051	1	Bolt	USE WITH 101381
	500052	1	Nut	USE WITH 101381
	353445X1	1	Lock Washer	USE WITH 101381
11	825141M1	1	Gasket	
12	825145M1	2	Stud	
	353431X1	2	Nut Unf	
	353434X1	2	Lock Washer	
13	56182	1	Body	80 M/M PET.
13	56182	1	Body	85 M/M V.O.
	825446M1	1	Body	85 M/M PET.
	825446M1	1	Body	85 M/M V.O.
	825446M1	1	Body	85 M/M L.O.
	825496M1	1	Tap	85 M/M PET.
	825496M1	1	Tap	85 M/M V.O.
	825496M1	1	Tap	85 M/M L.O.
	827770M1	1	Body Pump	20C DIESEL
14	825144M1	1	Gasket	80 M/M PET.
14	825144M1	1	Gasket	85 M/M V.O.
14	825144M1	1	Gasket	20C DIESEL
	825386M1	1	Gasket	85 M/M PET.
	825386M1	1	Gasket	85 M/M V.O.
	825386M1	1	Gasket	85 M/M L.O.
15	354264X1	1	Bolt Unc	85 M/M PET.
15	354264X1	1	Bolt Unc	85 M/M V.O.

15	354264X1	1	Bolt Unc	85 M/M L.O.
	354267X1	2	Bolt Unc	
	354270X1	1	Bolt Unc	80 M/M PET.
	354270X1	1	Bolt Unc	85 M/M PET.
	354270X1	1	Bolt Unc	85 M/M V.O.
	354270X1	1	Bolt Unc	85 M/M L.O.
	354272X1	1	Bolt Unc	20C DIESEL
	353434X1	3	Lock Washer	80 M/M PET.
	353434X1	4	Lock Washer	85 M/M PET.
	353434X1	4	Lock Washer	85 M/M V.O.
	353434X1	4	Lock Washer	85 M/M L.O.
	353434X1	3	Lock Washer	20C DIESEL
				*
				209,810 AND FUTURE
				+
				ENGINE S170,174E AND
				FUTURE
