

"20" TRACTOR PARTS LIST

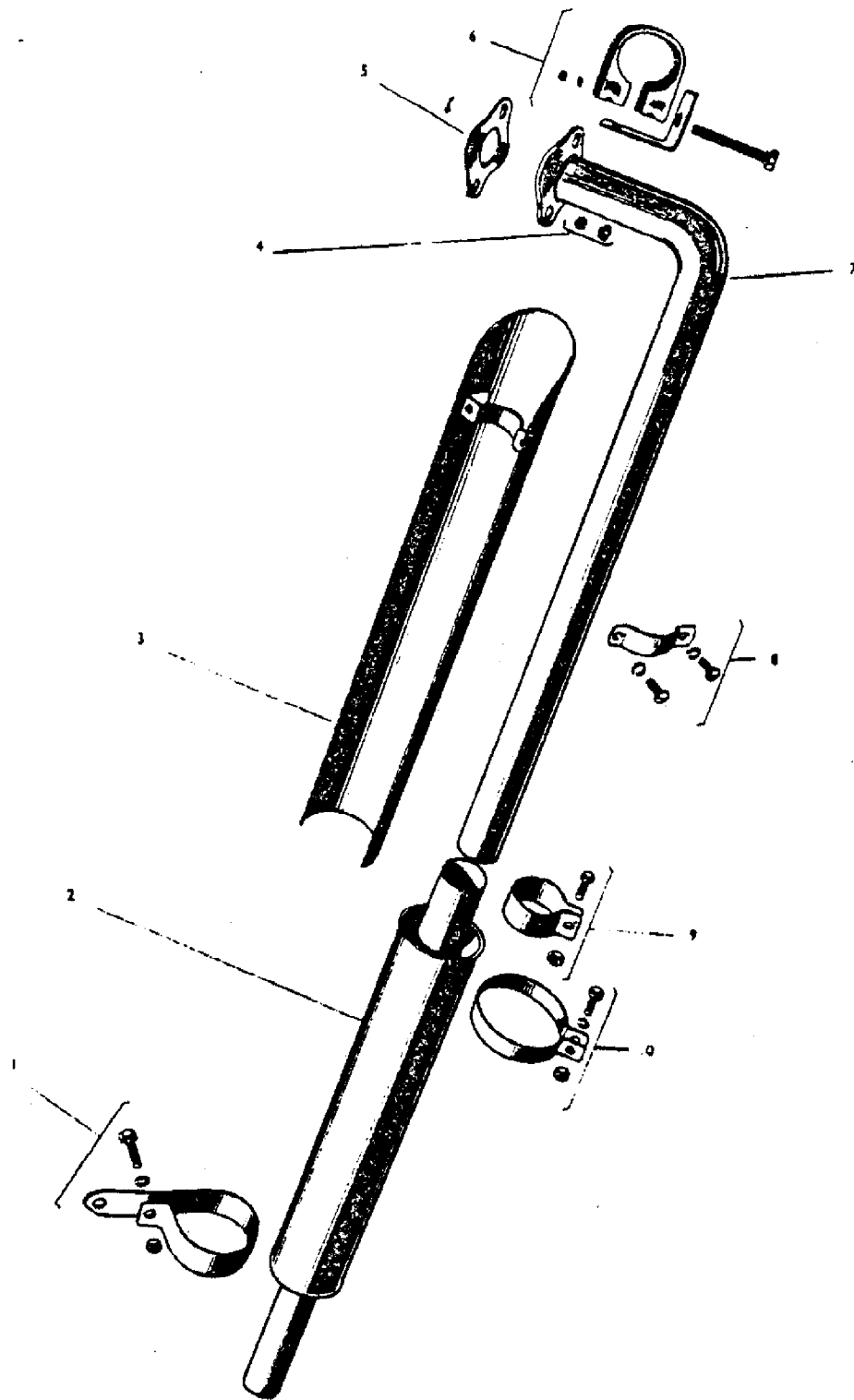

FIG. 34.

CTP 257

AGCO Corporation
Parts List Report

Massey Ferguson (Europe)

TE 20 TRACTOR

Page 124 - MUFFLER ASSEMBLY AND RELATED PARTS - 80 M/M PET., 85 M/M PET., 85 M/M V.O., 85 M/M L.O. 20C DIESEL.

Item	Part Number	Qty	Part Description	Comments
				80 M/M PET., 85 M/M PET., 85 M/M V.O., 85 M/M L.O. 20C DIESEL.
1	4111	1	Clip	
	353679X1	1	Screw Unc	
	355565X1	1	Nut Unc	
	353446X1	1	Lock Washer	
2	8539	1	Muffler	
3	8561	1	Shield	
4	825187M1	2	Nut	
	353434X1	2	Lock Washer	
	353756X1	1	Washer	20C DIESEL
5	825003M1	1	Gasket	
6	1954	1	Strap	80 M/M PET, 85 M/M PET, 85 M/M VO, 85 M/M LO
	2278	1	Bracket	20C DIESEL
	59027	1	Clip	
	354614X1	1	Bolt Unc	
	355565X1	1	Nut Unc	
	353755X1	1	Washer	
7	8584	1	Pipe	80 M/M PET
	8584	1	Pipe	(A) 85 M/M PET
	8756	1	Pipe	(B) 85 M/M PET
	8756	1	Pipe	85 M/M VO, 85 M/M LO
	8640	1	Pipe	20C DIESEL
8	1276	1	Clip	
	353989X1	2	Screw Unc	
	353441X1	2	Lock Washer	
9	180070M1	1	Clip	
	353669X1	1	Screw Unc	
	355564X1	1	Nut Unc	
	353441X1	1	Lock Washer	
10	1383	1	Clip	
	353669X1	1	Screw Unc	
	355564X1	1	Nut Unc	
	353441X1	1	Lock Washer	

(A)

Up to Serial or Engine Number 200,000

(B)

From Serial or Engine Number 200,001
