

"20" TRACTOR PARTS LIST

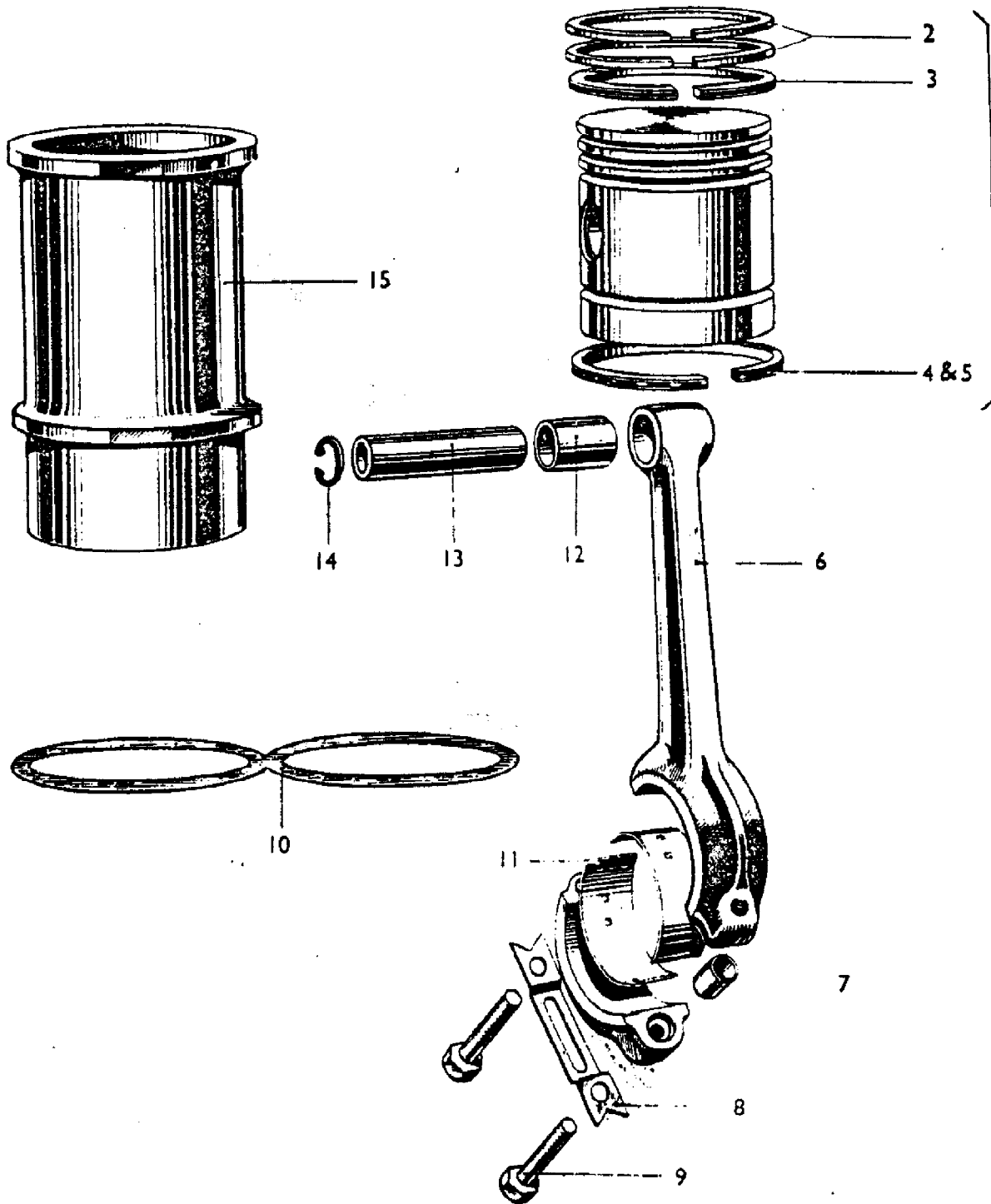

FIG. 23

AGCO Corporation
Parts List Report

Massey Ferguson (Europe)

TE 20 TRACTOR

Page 66 - PISTON, CONNECTING ROD, SLEEVE AND RELATED PARTS - 80 M/M PET., 85 M/M PET., 85 M/M V.O., 85 M/M L.O.

Item	Part Number	Qty	Part Description	Comments
				80 M/M PET., 85 M/M PET., 85 M/M V.O., 85 M/M L.O.
1	58141	4	Piston	80 M/M PET
	58141/2	AR	Piston	80 M/M PET .020" OVERSIZE
	57736	4	Piston	80 M/M PET 90 MM
	61433	4	Piston	80 M/M PET *
	61435	4	Cylinder Block	80 M/M PET *
	200570	4	Piston	85 M/M PET
	200570/2	AR	Piston	85 M/M PET .020" OVERSIZE
	200103	4	Piston	85 M/M VO * (+)
	200103/2	AR	Piston	85 M/M VO .020" OVERSIZE
	102968	4	Piston	85 M/M VO * (A)
	102968/2	AR	Piston	85 M/M VO .020" OVERSIZE
	200470	4	Piston	85 M/M LO *
	200470/2	AR	Piston	85 M/M LO .020"
2	60128	4	Ring	80 M/M PET 3/52" WIDE
	60128/1	AR	Ring	80 M/M PET .010" OVERSIZE
	60128/2	AR	Ring	80 M/M PET .020" OVERSIZE
	60128/3	AR	Ring	80 M/M PET .030" OVERSIZE
	101706	4	Ring	85 M/M PET, 85 M/M VO, 85 M/M LO .0787" WIDE
	101706/1	AR	Ring	85 M/M PET, 85 M/M VO, 85 M/M LO

				.010" OVERSIZE
	101706/2	AR	Ring	85 M/M PET , 85 M/M VO, 85 M/M LO
				.020" OVERSIZE
	101706/3	AR	Ring	85 M/M PET , 85 M/M VO, 85 M/M LO
				.030" OVERSIZE
3	60128	4	Ring	80 M/M PET 3/52" WIDE
	60128/1	AR	Ring	80 M/M PET .010" OVERSIZE
	60128/2	AR	Ring	80 M/M PET .020" OVERSIZE
	60128/3	AR	Ring	80 M/M PET .030" OVERSIZE
	101706	4	Ring	85 M/M PET .0787" WIDE
	101706	8	Ring	85 M/M VO, 85 M/M LO .0787" WIDE
	101706/1	AR	Ring	85 M/M PET , 85 M/M VO, 85 M/M LO
				.010" OVERSIZE
	101706/2	AR	Ring	85 M/M PET , 85 M/M VO, 85 M/M LO
				.020" OVERSIZE
	101706/3	AR	Ring	85 M/M PET , 85 M/M VO, 85 M/M LO
				.030" OVERSIZE
4	60129	4	Ring	80 M/M PET 3/16" WIDE-SLOTTED
	60129/1	AR	Ring	80 M/M PET .010" OVERSIZE
	60129/2	AR	Ring	80 M/M PET .020" OVERSIZE
	60129/3	AR	Ring	80 M/M PET .030" OVERSIZE
	60316	4	Ring	85 M/M PET , 85 M/M VO 3/16" WIDE-SLOTTED
	60316/1	AR	Ring	85 M/M PET , 85 M/M VO .010" OVERSIZE
	60316/2	AR	Ring	85 M/M PET , 85 M/M VO .020" OVERSIZE
	60316/3	AR	Ring	85 M/M PET , 85 M/M

			VO
			.030" OVERSIZE
	101708	4 Ring	85 M/M LO
	101708/1	AR Ring	85 M/M LO
			.010" OVERSIZE
	101708/2	AR Ring	85 M/M LO
			.020" OVERSIZE
	101708/3	AR Ring	85 M/M LO
			.030" OVERSIZE
5	60133	4 Primer	80 M/M PET
			5/32" WIDE-SLOTTED
	60133/1	AR Scraper	80 M/M PET
			.010" OVERSIZE
	60133/2	AR Ring	80 M/M PET
			.020" OVERSIZE
	60133/3	AR Ring	80 M/M PET
			.030" OVERSIZE
	60253	4 Ring	85 M/M PET, 85 M/M
			VO
			5/32" WIDE-SLOTTED
	60253/1	AR Ring	85 M/M PET, 85 M/M
			VO
			.010" OVERSIZE
	50253/2	AR Ring	85 M/M PET, 85 M/M
			VO
			.020" OVERSIZE
	60253/3	AR Ring	85 M/M PET, 85 M/M
			VO
			.030" OVERSIZE
	101708	4 Ring	85 M/M LO
	101708/1	AR Ring	85 M/M LO
			.010" OVERSIZE
	101708/2	AR Ring	85 M/M LO
			.020" OVERSIZE
	101708/3	AR Ring	85 M/M LO
			.030" OVERSIZE
6	58393/094	4 Rod	Up to Serial or Engine Number SC45,136E
			Up to Serial or Engine Number S212,883E
			Up to Serial or Engine Number SB9,644E
	58393/951	4 Rod	80 M/M PET
			Up to Serial or Engine Number SC45,136E
			Up to Serial or Engine Number S212,883E
			Up to Serial or Engine Number SB9,644E
	825456M91	4 Rod	85 M/M PET, 85 M/M
			VO, 85 M/M LO
7	825304M1	8 Bush	

8	825140M1	4	Washer	
9	825381M1	8	Bolt	
	56212	8	Bolt	80 M/M PET
10	56285	2	Gasket	80 M/M PET
	56286	2	Gasket	85 M/M PET , 85 M/M VO, 85 M/M LO
11	56252	4	Bearing	80 M/M PET (4 PR)
	56252/2	AR	Bearing	80 M/M PET .020" UNDERSIZE
	56252/3	AR	Bearing	80 M/M PET .030" UNDERSIZE
	56252/4	AR	Bearing	80 M/M PET .040" UNDERSIZE
	825315M1	4	Bearing	(4 PR)
	825316M1	AR	Bearing	.010" UNDERSIZE
	825317M1	AR	Bearing	.020" UNDERSIZE
	825318M1	AR	Bearing	.030" UNDERSIZE
	825319M1	AR	Bearing	.040" UNDERSIZE
12	825146M1	4	Bush	
13	60130	4	Clevis Pin	80 M/M PET
	825667M1	4	Pin	85 M/M PET , 85 M/M VO, 85 M/M LO
14	825113M1	8	Circlip	
15	56203	4	Kit, Joint	80 M/M PET *
	56205	4	Liner	85 M/M PET , 85 M/M VO, 85 M/M LO *
				NOT ILLUSTRATED
	501364	AR	Piston	80 M/M PET
	501365	AR	Piston	85 M/M PET
	501366	AR	Piston	85 M/M VO
	501367	AR	Piston	85 M/M VO
				(*) AVAILABLE IN GRADES F, G, AND H (+) Up to Serial or Engine Number S170173E (V.O.) (A) From Serial or Engine Number S170174E (V.O.)
