

"20" TRACTOR PARTS LIST

FIG. 16

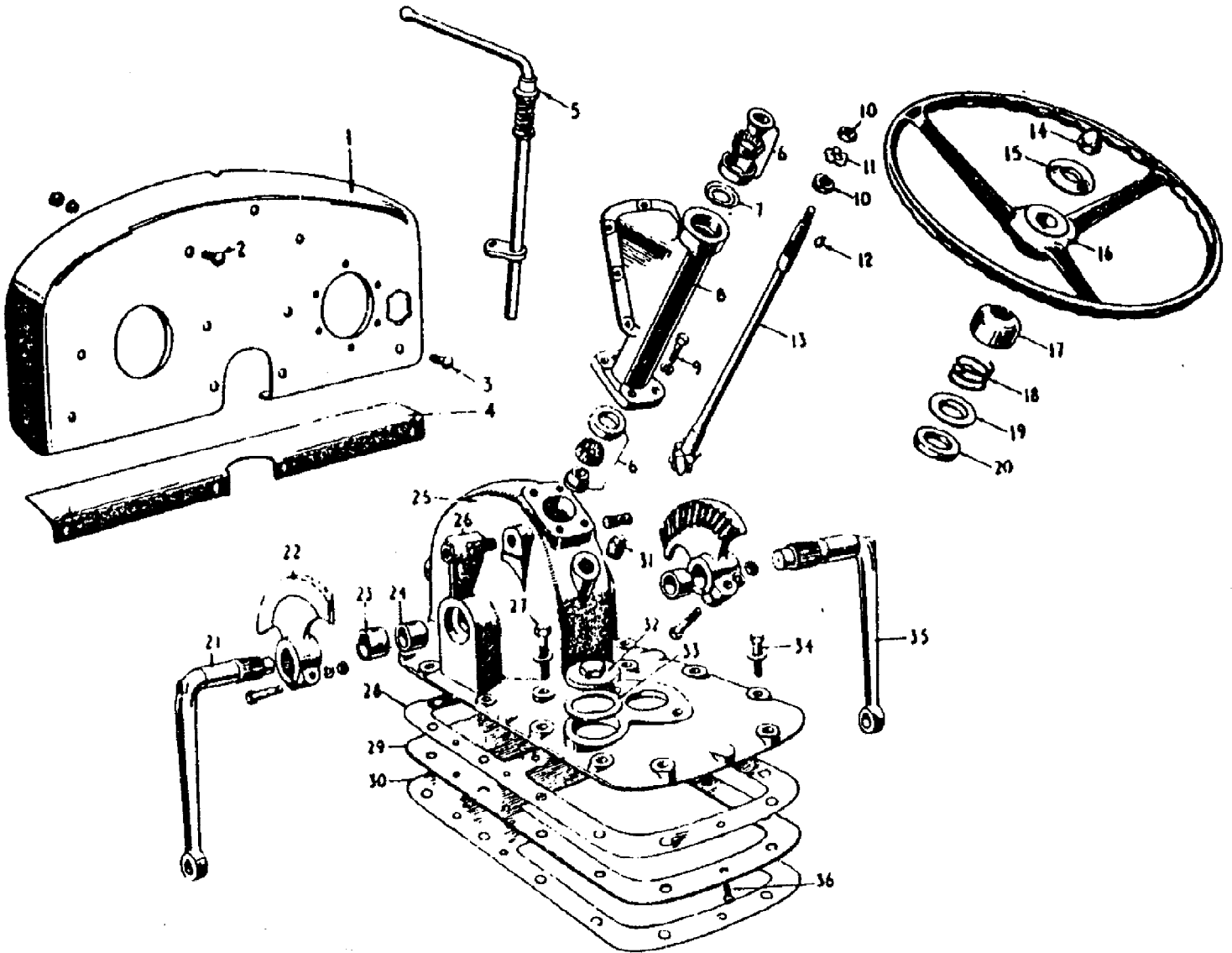

AGCO Corporation
Parts List Report

Massey Ferguson (Europe)

TE 20 TRACTOR

Page 42 - INSTRUMENT PANEL AND STEERING ASSEMBLY - 80 M/M PET., 85 M/M PET., 85 M/M V.O.,
85 M/M L.O., 20C DIESEL

Item	Part Number	Qty	Part Description	Comments
				80 M/M PET., 85 M/M PET., 85 M/M V.O., 85 M/M L.O., 20C DIESEL
1	2012	1	Instrument Panel	80 M/M PET., 85 M/M PET., 85 M/M V.O.
	2012	1	Instrument Panel	(A) 85 M/M PET., 85 M/M V.O.
	2407	1	Panel	(A) 85 M/M L.O.
	2504	1	Instrument Panel	(B) 85 M/M PET., 85 M/M V.O., 85 L.O.
	102797	1	Panel	20C DIESEL
	1944	1	Gasket	
	2414	1	Grommet	(A) 85 M/M L.O.
	2622	1	Insert	(B) 85 M/M PET., 85 M/M V.O., 85 L.O.
	7330	1	Intake	(B) 85 M/M PET., 85 M/M V.O., 85 L.O.
	7331	1	Cover	(B) 85 M/M PET., 85 M/M V.O., 85 L.O.
	19FSR50B	1	Screw	(B) 85 M/M PET., 85 M/M V.O., 85 L.O.
	103119	1	Bracket Assy.	20C DIESEL
	14027X	10	Rivet	20C DIESEL
2	31FBR75B	7	Bolt	
	353446X1	7	Lock Washer	
	353916X1	7	Nut Unf	
3	31FBR75B	2	Bolt	
	353446X1	2	Lock Washer	
	1416	4	Washer	
	353916X1	2	Nut Unf	
4	7093	1	Bearer	80 M/M PET., 85 M/M PET., 85 M/M V.O., 85 M/M L.O.
	200645	1	Reinforcement	20C DIESEL
5	7266	1	Control	80 M/M PET., 85 M/M PET., 85 M/M V.O., 85 M/M L.O.
	7266	1	Control	(A) 80 M/M PET., 85 M/M PET., 85 M/M V.O., 85 M/M L.O.
	7325	1	Control	(B) 85 M/M PET., 85 M/M V.O., 85 L.O.
	200642	1	Control	20C DIESEL

6	1251	2	Kit, Bearing	
7	1254	1	Washer	
8	8537	1	Housing	
9	353701X1	4	Screw Unc	
	353432X1	4	Lock Washer	
10	1265	2	Nut	
11	1271	1	Washer	
12	2951X	1	Key	
13	4393	1	Shaft	
14	195592M1	1	Nut	
15	1258	1	Washer	
16	180576M1	1	Wheel	
17	1257	1	Cap	
18	1259	1	Spring	
19	1256	1	Retainer	
20	1255	1	Gasket	FROM 465,927 - DIESEL ONLY.
	2648	1	Gasket	Up to Serial or Engine Number 465,926
21	7163	1	Arm	Left Hand
22	7269	2	Sector	
	353708X1	2	Bolt Unc	
	355645X1	2	Nut Unc	
	353432X1	2	Lock Washer	
23	1279	2	Bush	
24	1280	1	Bush	
	2248	1	Steering Housing	
25	1830	1	Housing	
	1481	2	Stud	
	353426X1	2	Nut Unf	
	353432X1	2	Lock Washer	
26	1388	2	Screw	
	353436X1	2	Nut Unf	
27	353707X1	2	Screw Unc	
	353706X1	2	Bolt Unc	
	1146	2	Washer	
28	7116	1	Gasket	
29	7177	1	Plate	
30	7083	1	Gasket	
31	195251M1	1	Plug	
32	1018	1	Plug	
33	1170	1	Roller Frame	
34	353705X1	12	Bolt Unc	
	353703X1	12	Bolt Unc	
	1146	12	Washer	
35	7162	1	Arm	Right Hand
36	1547	10	Screw	

NOT ILLUSTRATED

1578	2	Gasket	
7152	1	Tube	Up to Serial or Engine Number 200,000
8781	1	Tube	From Serial or Engine Number 200,001
103015	1	Tube	
200852	1	Pipe	
827622M1	1	Adaptor	
103271	1	Clip	
827632M1	1	Fastener	
1804	1	Clamp	
1805	1	Nut	
1806	1	Lock Washer	
1850377M91	1	Gauge	

(A)

Up to Serial or Engine Number 200,000

(B)

From Serial or Engine Number 200,001
