

"20" TRACTOR PARTS LIST

FIG. 13

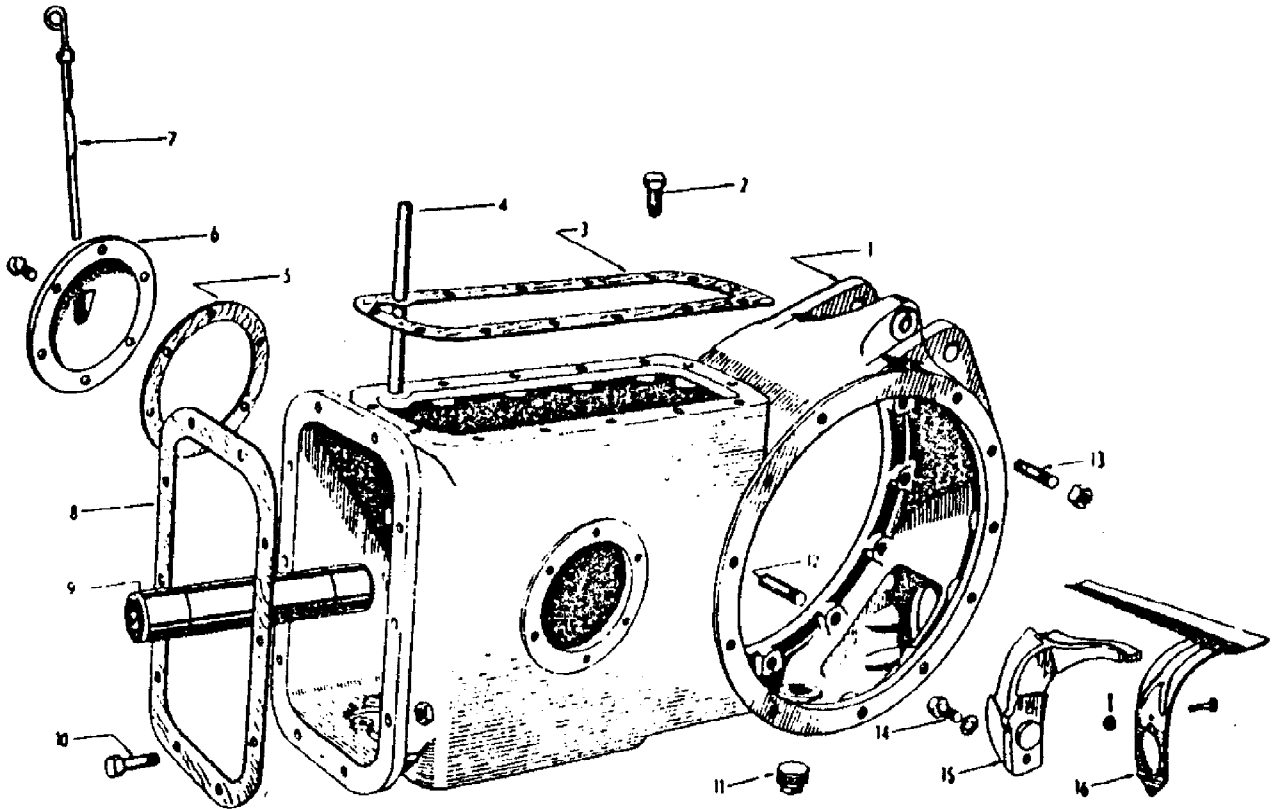

AGCO Corporation  
Parts List Report

Massey Ferguson (Europe)

TE 20 TRACTOR

Page 34 - CENTRE AXLE HOUSING AND RELATED PARTS - 80 M/M PET., 85 M/M PET., 85 M/M V.O.,  
85 M/M L.O., 20C DIESEL

Item	Part Number	Qty	Part Description	Comments
				80 M/M PET., 85 M/M PET., 85 M/M V.O., 85 M/M L.O., 20C DIESEL
1	9516	1	Housing	80 M/M PET.
1	9516	1	Housing	(B)
	400210	1	Housing	85 M/M PET., 85 M/M V.O., 85 M/M L.O., 20C DIESEL. (C)
				85 M/M PET., 85 M/M V.O., 85 M/M L.O., 20C DIESEL.
2	353710X1	3	Bolt Unc	
	353702X1	7	Bolt Unc	
	353719X1	4	Bolt Unc	
3	7042	1	Gasket	
4	1026	1	Tube	
5	1077	2	Gasket	
6	4083	1	Cover	
	353696X1	6	Screw Unc	
7	1139	1	Indicator	
8	181363M1	1	Gasket	
9	4381	1	Shaft	
10	353564X1	7	Bolt Unf	80 M/M PET., 85 M/M PET., 85 M/M V.O., 85 M/M L.O.
10	353564X1	7	Bolt Unf	(A)
				80 M/M PET., 85 M/M PET., 85 M/M V.O., 85 M/M L.O.
	353426X1	7	Nut Unf	80 M/M PET., 85 M/M PET., 85 M/M V.O., 85 M/M L.O.
	353426X1	7	Nut Unf	(A)
				80 M/M PET., 85 M/M PET., 85 M/M V.O., 85 M/M L.O.
	353701X1	3	Screw Unc	80 M/M PET.
	353701X1	4	Screw Unc	85 M/M PET., 85 M/M V.O., 85 M/M L.O., 20C DIESEL.
	353564X1	9	Bolt Unf	
	353426X1	9	Nut Unf	
11	195251M1	1	Plug	
12	1249	1	Stud	
	353428X1	1	Nut Unf	85 M/M PET., 85 M/M V.O., 85 M/M L.O., 20C DIESEL.
13	1249	20	Stud	20 OFF UP TO 325,000.
				80 M/M PET.
	1249	28	Stud	20 OFF UP TO 325,000.
				85 M/M PET., 85 M/M V.O., 85 M/M L.O., 20C DIESEL.
	353426X1	20	Nut Unf	20 OFF UP TO 325,000.
				80 M/M PET.
	353426X1	28	Nut Unf	20 OFF UP TO 325,000.

---

				85 M/M PET., 85 M/M V.O., 85 M/M L.O., 20C DIESEL.
	353702X1	1	Bolt Unc	NOT ILLUSTRATED
14	353691X1	2	Screw Unc	
	353434X1	2	Lock Washer	
15	7015	1	Catch	80 M/M PET.
	7015	1	Catch	(B)
				85 M/M PET., 85 M/M V.O., 85 M/M L.O., 20C DIESEL.
	1502	AR	Shim	Thickness: 0.002"
	1503	AR	Shim	Thickness: 0.003"
	1504	AR	Shim	Thickness: 0.005"
	825774M1	1	Block	(C)
16	4019	1	Trough	80 M/M PET.
	4019	1	Trough	(B)
				85 M/M PET., 85 M/M V.O., 85 M/M L.O., 20C DIESEL.
	181225M91	1	Trough	(C)
	354007X1	2	Bolt	
	353922X1	2	Nut Unf	
	354040X1	2	Pin	
				NOT ILLUSTRATED
	104104	1	Rim	(A)
				Up to Serial or Engine Number 200,000
				(B)
				Up to Serial or Engine Number 325,000
				(C)
				From Serial or Engine Number 325,001

---